



## DRIVE SHP305 - 70/180W

70 - 180 watt, IP66 LED street luminaire, IK08 rated

### Application

A decorative, streamline exterior commercial solution

### Design Specifications



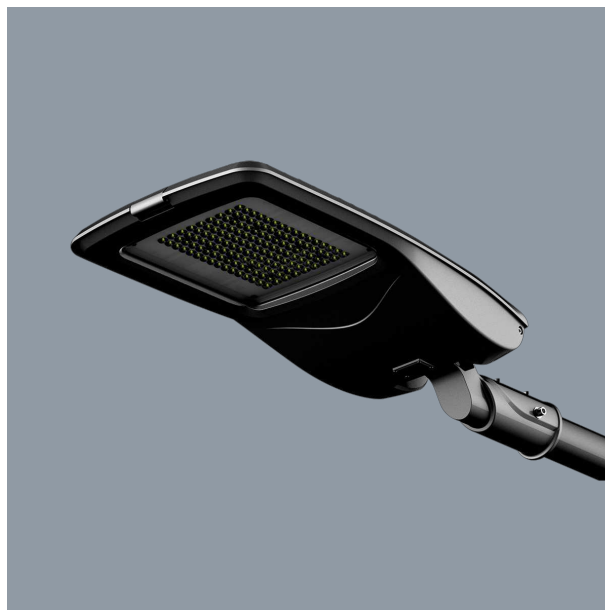



- Stylish die-cast aluminium body, durable powder coated Black finish as standard, (RAL9017).
- Integral constant current non-dimmable LED driver as standard, CCT 5000K standard, 4000K optional to order
- Asymmetrical light distribution (TYPE II) fitted, 0% upward light ratio, clear tempered glass diffuser
- Standard 3G.ANSI C.136.31-2010 Ø 60 pole mounting bracket, 800 mm 3 core rubber flex
- Optional integral constant current dimmable LED driver with 3 IN 1 dimming LED driver (1-10V DC, PWM signal & resistance)
- Lens option (refer to Photometric data below)  
SHP305A75/P (standard), SHP305A45/P (option), optional PE cell configurations available



### Performance

- Dimmable - **OPTIONAL**
- Dimmer Type - **1-10V DC**
- In Built Sensor - **OPTIONAL**

## Technical Specification

Product	Model No.	Input Voltage (V/AC)	Power (W)	Lumens (lm)	CCT (K)	CRI
	SHP305/70NDL/BK	240	70	9100	5000	70
	SHP305/90NDL/BK	240	90	11700	5000	70
	SHP305/90CWL/BK	240	90	10800	4000	70
	SHP305/120NDL/BK	240	120	15600	5000	70
	SHP305/150NDL/BK	240	150	19500	5000	70
	SHP305/180NDL/BK	240	180	23400	5000	70

Body Colour	Mass (kg)	Length (mm)	Width (mm)	Height (mm)
BLACK	8.8	763	352	167
BLACK	9	763	352	167
BLACK	9	763	352	167
BLACK	9.2	763	352	167
BLACK	9.5	763	352	167
BLACK	9.6	763	352	167

Due to continued product and technology enhancements, data sourced from sal.net.au shall not form part of any contract and or technical performance guarantee unless expressly confirmed in writing by SAL at the time of order. Products are sold in accordance with [SAL Terms and Conditions of sale](#) and all images shown are for illustration purposes only and may vary from the actual colour or finish. Unless specifically stated, all IP ratings nominated for Interior products are from "below the ceiling".

## Dimensions

SHP305

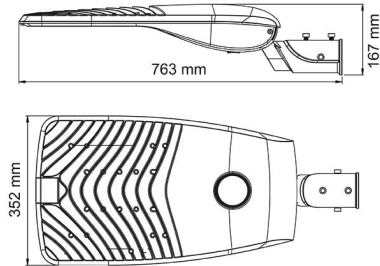

SHP305/6WB/BK WALL

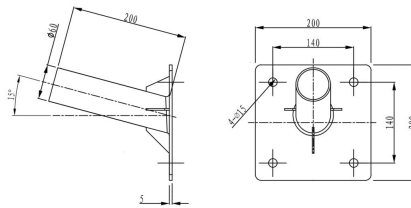

## Photometric Data

Unit: cd C0/C180 — C90/C270 —

SHP305/70NDL at 5000K  
with SHP305A75/P

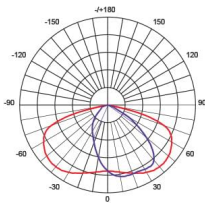

SHP305/180NDL at 5000K  
with SHP305A45/P

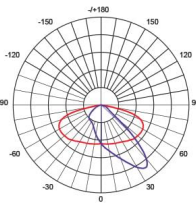

At SAL we are always thinking about how we can enhance our customers lighting experience & strongly believe **OUR SUCCESS IS MEASURED BY OUR CUSTOMERS SUCCESS.**



For more  
information  
please  
scan me

